

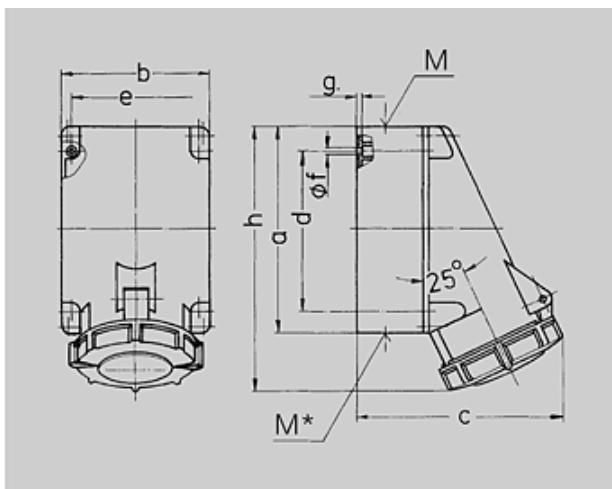

 Part no. : 136A
Receptacle

internal fixing, 1 cable entry at top and two blind cable entries (can be cut out) at bottom,
 bottom part of enclosure can be turned 180°, with 6 blind holes for mounting special terminals
 if required

Sleeves: SoftCONTACT







Contact carrier: Highly heat resistant



Drawing	Amp.	63			
		3	4	5	
1 MB 112	Poles				
Dim. in mm	a	170	170	170	
	b	118	118	118	
	c	171	171	171	
	d	134,5	134,5	134,5	
	e	103	103	103	
	f	6,1	6,1	6,1	
	g	6	6	6	
	h	216	216	216	
	M	40	40	40	
	M*		2x M 40		
	Max. cabel diam. (mm)		32	32	32
	Terminal for cond. cross section (mm²) min.-max.		6 —25	6 —25	6 —25

Article-group : 1049
 voltages : 400V
 rated current : 63A
 pole : 5 pole
 IP protection types : IP67
 position of ground contact : 6h
 packing unit : 0005
 weight : 970 g

PART NUMBERS

V	110V	230V	400V	500V	>50-500V	
Hz	50,60	50,60	50,60	50,60	100-300	300-500
colour						
amp.						
63 A	3	856	128A	129A		
	4	130A	131A	132A	133A	
	5	134A	135A	136A	2007A	