

Catalogue No: **100-C30D00**
CONTACTOR 15kW 3P 110V AC COIL

Motor Control and Drives > Motor Starting and Protection > Contactors > Allen-Bradley Contactors > Bulletin 100-C Contactors > 3-Pole Contactors with AC Coil



Contactor 3 pole 30A 15kW 120V 60Hz 110V 50Hz AC Coil

- Available in AC or DC control coil versions to suit application requirements
- Common accessories for all size contactors, minimising inventory and maximising flexibility
- Reversible (line or load side) coil terminations for total flexibility
- DIN rail mountable for easy installation

Representative Photo Only
 (actual product may vary based on configuration selections)

SPECIFICATIONS

| | |
|---|--------------------|
| Product Series | 100-C |
| Component Type Motor Control and Drives | Standard Contactor |
| Ie, Rated Operational Current, AC-1, 415V, 40°C | 65 A@415V,40°C |
| kW Rating, AC-3, 415V, 60°C | 15 kW @415V, 60°C |
| Ie, Rated Operational Current, AC-3, 415V, 60°C | 30 A@415V,60°C |
| kW Rating, AC-3, 690V, 60°C | 15 kW @690V, 60°C |
| Ie, Rated Operational Current, AC-3, 690V, 60°C | 18 A@690V,60°C |
| Number of Poles | 3 |
| Contact Configuration, Main Poles | 3 NO main poles |
| Coil Type | Conventional type |
| Coil Voltage | 110 V AC V |
| IP Rating | IP20 |

REFERENCES

| | |
|---|---|
| IECEx Certificate | - |
| Supplier Declaration of Conformity: | - |
| Installation Guide: | - |
| User Manual: | - |
| Manufacturer Datasheet: | - |
| Manufacturer Catalogue & Product Selection: | - |

Catalogue No: **100-C30D00**
CONTACTOR 15kW 3P 110V AC COIL

Motor Control and Drives > Motor Starting and Protection > Contactors > Allen-Bradley Contactors > Bulletin 100-C Contactors > 3-Pole Contactors with AC Coil

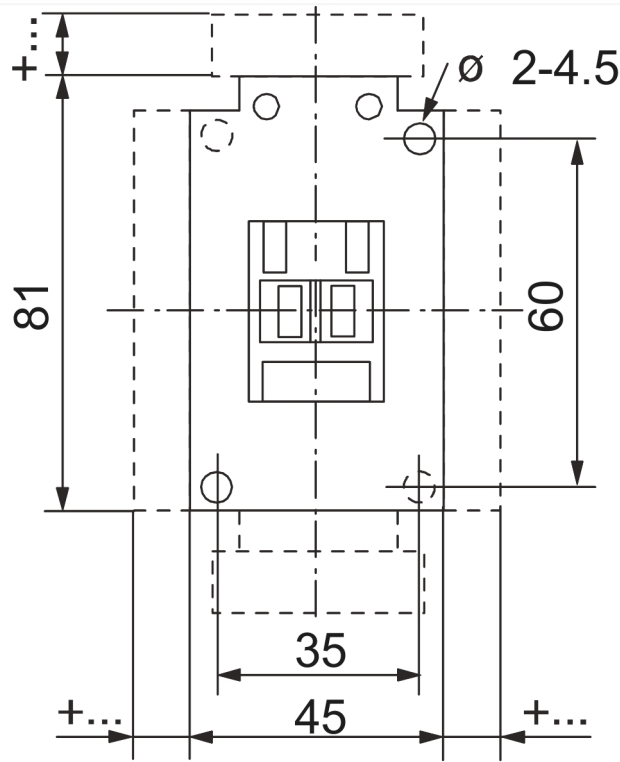

Dimension Diagram